

LEGEND

- | | |
|--|--|
| <ul style="list-style-type: none"> ① ID WIRE PATH TWISTED TO NEXT DECODER ② WATERPROOF SPLICES, 3M-DBY (4) ③ WATERPROOF SPLICES, 3M-DBY-6 (3) ④ SOLENOID LEADS (SEE NOTE FOR COLORS), UP TO 150FT [45M] FROM DECODER ⑤ MODEL D200 DECODER | <ul style="list-style-type: none"> ⑥ GROUND WIRE TO EARTH, INSTALLED PER ASIC GUIDELINES. 1 PER 12 DECODERS OR EVERY 1,000FT [330M] ⑦ ID WIRE PATH FROM CONTROLLER, ALLOW 2.5FT [76CM] MINIMUM OF SLACK AT EACH SIDE OF DECODER. |
|--|--|

NOTE: ALL D200 DECODERS SHALL HAVE THE FOLLOWING ADDRESSES AND CORRESPONDING COLOR:

ADDRESS 1 = BLACK

ADDRESS 2 = YELLOW

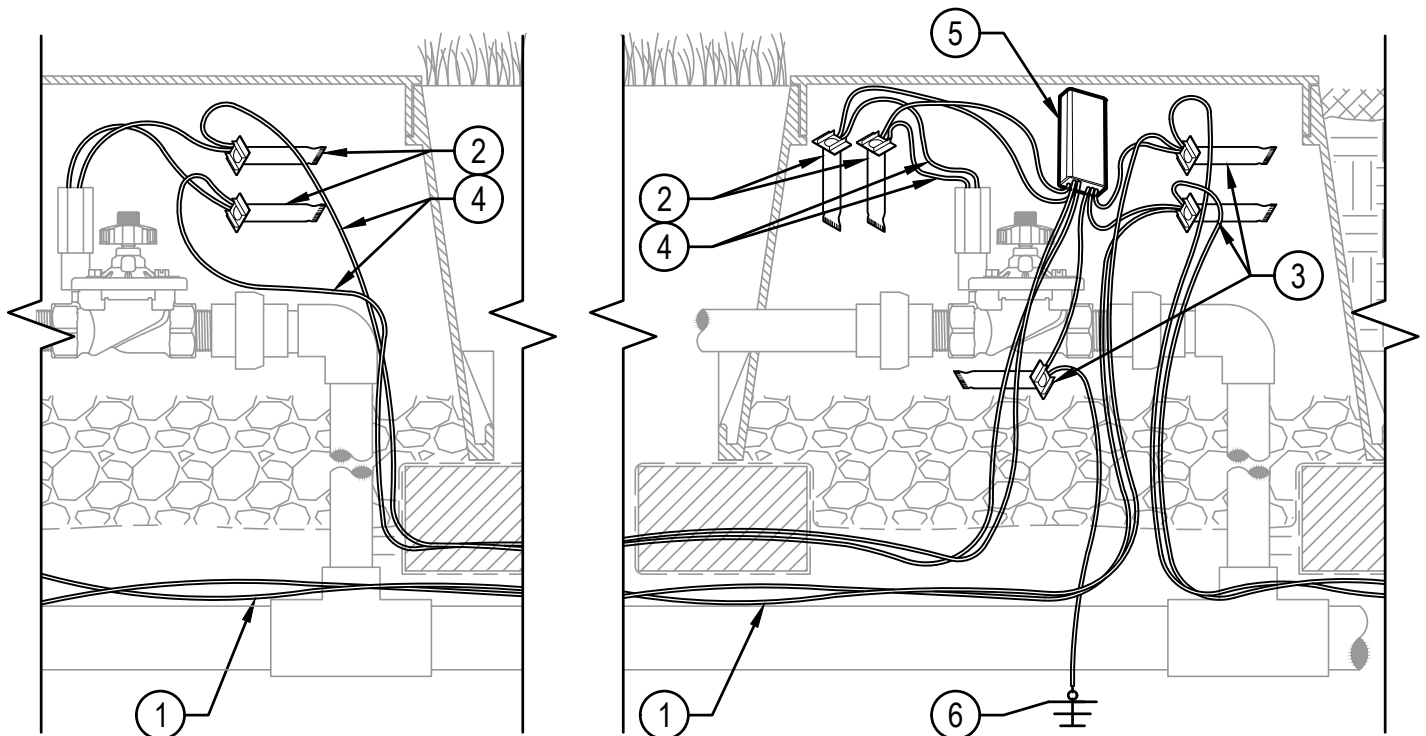

DECODER IN VALVE BOX (D200)

Hunter® D.200.01

NO SCALE